



2020

**SEEDING
PROGRAM**

Making **your seeding
program** more efficient.



CONTENTS

- 3 CULTIVATORS – POINT BOOT KITS
- 4 CULTIVATORS – SLOT MATE
- 5 CULTIVATORS – SINGLE BOLT/SEED DRILLS
- 6 CULTIVATORS – BOLT ON/WEDGES
- 7 CULTIVATORS – EZI FIT SYSTEM
- 8 CULTIVATORS – CONVENTIONAL SEED BOOTS
- 9 CULTIVATORS – CONVENTIONAL SEED BOOTS
- 10 CULTIVATORS – INLINE SERIES SEED BOOTS
- 11 MORRIS / BOURGAULT – PRECISIONS SEEDERS
- 12 SLOT MATE A – FIT AUSPLOW BARS
- 13 JD CONSERVA PAK PARTS
- 14 PRESS WHEELS – SINGLE SYSTEM
- 15 PRESS WHEELS – TRIPLES / GANGS
- 16 COULTERS
- 17 AIRGUARD SEED BRAKES
- 18 AIRGUARD BLOCKAGE PREVENTION SYSTEM
- 19 FASTENERS AND ACCESSORIES



MAKING YOUR SEEDING PROGRAM MORE EFFICIENT



Australian Made since 1994

In this catalogue, we refer to the names and trade marks of a number of machinery suppliers for the purpose of identifying the machines with which our parts can be used. There is no relationship between Maxipoint and these machinery suppliers and the use of our parts has not necessarily been approved by such suppliers. However, Maxipoint does endeavour to work closely with seeding bar manufacturers to design seeding tools that are suitable for Australian conditions and fit within the working parameters of the seeding bar.

POINT BOOT KITS

All Point & Boot Kits Include:

- Boot Kit
- Slot Mate Adaptor
- Lynch Pin
- Slot Mate Knife Point
- 2 x 2¾ x ½ Gr.8 Hex Bolt/Nut
- Other Bolts and Nuts to suit

Boot Kit Checklist

SYSTEM		SEED HOSE OD	
Single Shoot	<input type="checkbox"/>	32mm	<input type="checkbox"/>
Double Shoot	<input type="checkbox"/>	38mm	<input type="checkbox"/>
BACKSHOOT		SHANK TYPE	
Fixed 50mm (Single Row)	<input type="checkbox"/>	C Shank 1/2"	<input type="checkbox"/>
Fixed 30mm (Single Row)	<input type="checkbox"/>	C Shank 7/16"	<input type="checkbox"/>
Split 40mm	<input type="checkbox"/>	Horwood Curved	<input type="checkbox"/>
Split 70mm	<input type="checkbox"/>	Horwood Straight	<input type="checkbox"/>
Flexi	<input type="checkbox"/>	Gason	<input type="checkbox"/>
Side Banded	<input type="checkbox"/>	Simplicity	<input type="checkbox"/>
		Flexicoil Edge On	<input type="checkbox"/>
POINT			
SMV	<input type="checkbox"/>	Other: _____	
SMV 15mm	<input type="checkbox"/>		
SMV SLL(add \$20)	<input type="checkbox"/>		
SMV Short	<input type="checkbox"/>		
SMS	<input type="checkbox"/>		
SMS 15mm	<input type="checkbox"/>		
SMS SLL (add \$20)	<input type="checkbox"/>		
SMD	<input type="checkbox"/>		
SMF (add \$6)	<input type="checkbox"/>		
SM Razor 15mm (add \$10)	<input type="checkbox"/>		
SM Razor SLL (add \$30)	<input type="checkbox"/>		
		UPGRADES	
		Leech Pin (add \$7.50)	<input type="checkbox"/>
		Trash Guard (add \$26)	<input type="checkbox"/>

PB-1000	Single Shoot Fixed	\$154 + GST
PB-1100	Single Shoot Split	\$174 + GST
PB-1200	Single Shoot Flexi	\$178 + GST
PB-2000	Double Shoot Fixed	\$171 + GST
PB-2100	Double Shoot Split	\$191 + GST
PB-2200	Double Shoot Flexi	\$196 + GST

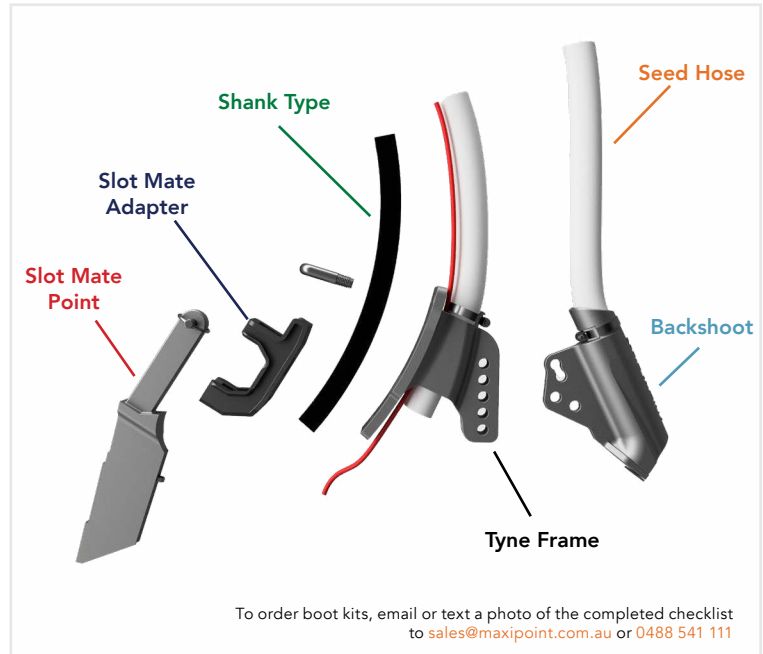

SLOT MATE RANGE

Slot Mate V

- The original Slot Mate
- Working angle for minimum till seeding.
- Various Tungsten options available

12mm	PT-1SMV	\$55
15mm	PT-1SMV5	\$59
SLL	PT-1SMV8	\$79

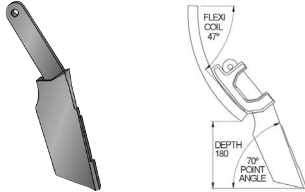

Slot Mate V Short 5"

- Shortest point in the range.
- For use with hard ground, rough or rocky paddocks.

12mm	PT-1SMVC	\$55
15mm	PT-1SMV5C	\$59

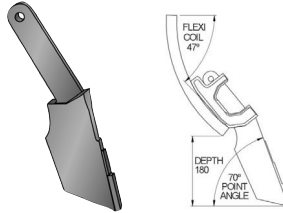

Slot Mate Razor

- Low soil disturbance.
- Easier pulling, less drag.

15mm	PT-1085	\$61
SLL*	PT-1086	\$81



Slot Mate Sweep

- Quick change sweep.
- Extra hardfacing on wing tips.

4"	PT-2020	\$43
6"	PT-2021	\$45
8"	PT-2022	\$47
10"	PT-2023	\$49
12"	PT-2024	\$51



Slot Mate S

- Straighter angled point
- Various tungsten options.
- Liquid hose holder – 8mm.

12mm	PT-1SMS	\$55
15mm	PT-1SMS5	\$59
SLL	PT-1SMS8	\$79

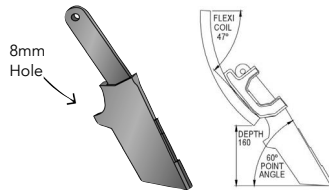

Slot Mate D

- Similar angle and depth to the bolt on Dyna Blade Curved
- 6" digging depth, 65° angle of attack

12mm	PT-1SMD	\$57
------	---------	------

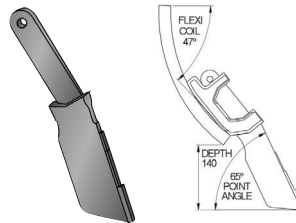

Slot Mate F

- Inverted T design for more soil disturbance
- 60mm wing with tungsten reinforcing

12mm	PT-SMF12	\$70
------	----------	------

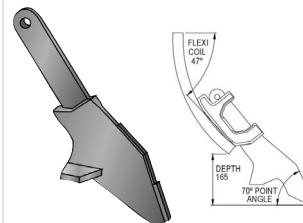

Slot Mate Tungsten Options



SLL = Super Long Life
All SLL Points include extra hardfacing on each side of the point.

All our tungsten, regardless of size, is the same high quality, high durability grade, sourced from long term and well established tungsten carbide suppliers.

Our tungsten is field tested and proven over many years of use in the hardest Australian conditions from abrasive sands to rocky paddocks, and we have found the optimum balance between hardness and resistance to shock impact.

UPGRADES

Trash Guard

Sturdy steel trash guard to give the tyre a streamlined shape.

PT-2002 **\$26**



Slot Mate Adaptor

1/2" PT-1SMA1/2
7/16" PT-1SMA7/16

\$9.50



Slot Mate E

Adaptor for using Ezi Fit range of points (see pg. 7).

PT-SMEA **\$18**



Hard Facing

Extra hardfacing on the side of points for superior wear protection.

PT-UPH **\$10**

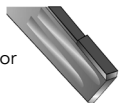

Liquid Nut

To hold liquid tube, specify tube OD on order.

PT-UPN **\$3**



Liquid Block

Similar to nut but gives added protection to the liquid tube. Specify tube OD on order.

PT-UPB **\$12**



SINGLE BOLT AND SEED DRILLS

Maxi Seeder

- Minimum till application with improved seed depth control
- Tungsten tipped leading edge and tungsten reinforced wing
- Common bolt size 7/16 x 2¼

PT-1001

\$54



Maxi Plus

- Same shape but bigger than the Maxi Seeder
- Wider, Deeper, Thicker and more tungsten
- Common bolt size 7/16 x 2¼

PT-1004

\$60



Pasture Point

- Tungsten tipped edge with tungsten reinforced wing
- Seed Drill Fitment
- PT-1014 = Connor Shea/Agrow/ Aitchison
- PT-1015 = Duncan

PT-1014

\$51

PT-1015

\$51



1 Bolt Ripper

- Common knife point. Fits most tyres
- Common bolt size 7 /16 x 2¼

PT-1007

\$47



Scari Ripper

- Knife point for scarifier tyres
- Common bolt size:½ x 2½

PT-1009

\$58



Maxi Knife

- No till design with tungsten edge
- Common bolt size 7/16 x2¼

PT-1002

\$46









BOLT ON/WEDGE POINTS

This range of points have been manufactured by Maxipoint for over 20 years. Durable, reliable and withstanding the test of time.

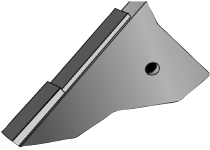
Dyna Blade Curved	Dyna Blade Flat	Ezi Blade Vertical	Ezi Blade Straight	
<ul style="list-style-type: none"> • Forged spring steel point • 6" digging depth designed for minimum soil throw • Suit curved C shank tynes 	<ul style="list-style-type: none"> • Forged spring steel point • 6" digging depth designed for minimum soil throw • Suit flat or edge on tynes 	<ul style="list-style-type: none"> • Suits slim line wedge system • 6" digging depth • 65° angle for minimum till seeding 	<ul style="list-style-type: none"> • Suits slim line wedge system • 6" digging depth • 60° angle of attack 	
<p>PT-112A \$63</p>	<p>PT-112B \$63</p>	<p>PT-113V \$58</p>	<p>PT-113S \$58</p>	
		 <p>Split pin included</p>	 <p>Split pin included</p>	
Flexiplus	2 Bolt Curved Adaptor	Wedge Adaptor	Wedge	2 Bolt Hole Adaptor
<ul style="list-style-type: none"> • Long lasting tungsten on leading edge • Tungsten reinforced 60mm wing • For tynes with 1/2" or 7/16" bolt holes 	<p>Adaptor for Ezi Fit range on 2 bolt hole C shank tynes See Ezi Fit range on page 7</p>	<p>Adaptor for Ezi Fit range on shanks with standard wedges See Ezi Fit range on page 7</p>	<ul style="list-style-type: none"> • Standard slim line wedge design • Suits Wedge Adaptors and Ezi Blades 	<ul style="list-style-type: none"> • Used to fix a single bolt point
<p>7/16" PT-105A \$68</p> <p>1/2" PT-105B \$68</p>	<p>PT-1E48 \$37</p>	<p>PT-1EWA \$23</p>	<p>1/2 x 45 PT-1MW1 \$17</p> <p>7/16 x 45 PT-1MW2 \$17</p> <p>1/2 x 57 PT-1MW3 \$17</p>	<p>PT-2011 \$21</p>
		 <p>Split pin included</p>		

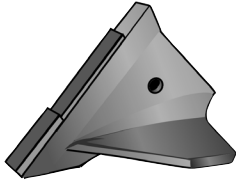
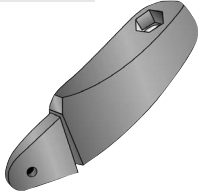
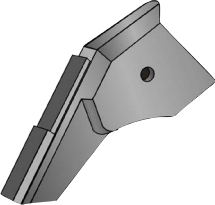
EZI FIT SYSTEM

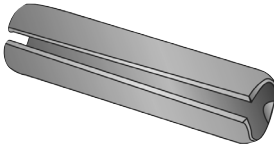
Ezi Fit System points are cast from extremely wear resistant Ni Hard 4 material.

Ezi Ripper	Ezi Seeder	Ezi Tiller	Culti Adaptor
<ul style="list-style-type: none"> Ezi Fit system knife point 100mm digging depth 	<ul style="list-style-type: none"> Ezi Fit system winged point 100mm digging depth 60mm wing width 	<ul style="list-style-type: none"> 100mm wing width 100mm digging depth for a wider full cut 	<ul style="list-style-type: none"> Adaptor for Ezi Fit range of points on Single Bolt Cultivators Common bolt size 7/16 x 2¼
<p>PT-10ER \$48</p>	<p>PT-10ES \$52</p>	<p>PT-10ET \$55</p>	<p>PT-1EW46 \$29</p>
			
Deep Ripper	Deep Seeder	Roll Pin	Scari Adaptor
<ul style="list-style-type: none"> Knife point 130mm digging depth 75° working angle 	<ul style="list-style-type: none"> 60mm wing width 130mm digging depth 75° working angle 	<ul style="list-style-type: none"> 1 roll pin required per point Recommended new roll pin fitted with point change 	<ul style="list-style-type: none"> Fits scarifier tynes. Common bolt size ½ x 2½
<p>PT-10DR \$49</p>	<p>PT-10DS \$53</p>	<p>PT-10EP \$1.00</p>	<p>PT-SA \$33</p>
			



CULTIVATORS – CONVENTIONAL SEED BOOTS

Maxipoint seed boot kits fit a wide range of machines and have adjustable height and closer angle options.

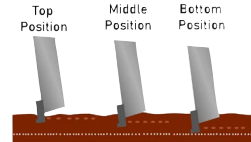

Height Options

Actual closer plate height depends on shank type image for indicative purposes only

- Heavy Duty construction
- Fit all 2 bolt tynes
- Boot Kits include bolts and fasteners
- When ordering boot kit or tyne frame *Please specify machine or tyne/shank type*
- U-Bolt used FA-0703
- Split boots available in 40mm or 70mm (For more tynes see page 11)

Single Shoot Fixed

SB-1230 **\$96**

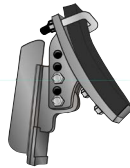

Single Shoot Split

SB-1232 **\$117**

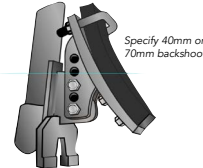

Single Shoot Flexi

SB-1234 **\$121**

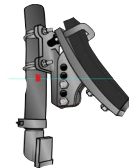

Tyne Frames

Single Shoot

SB-0231

\$49



Double Shoot

DB-0220

\$54



Double Shoot Fixed

DB-1220 **\$114**

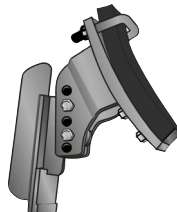

Double Shoot Split

DB-1222 **\$135**

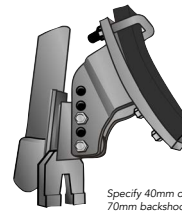

Double Shoot Flexi

DB-1224 **\$139**

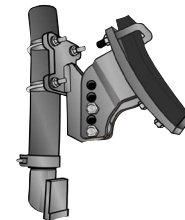

CULTIVATORS – CONVENTIONAL SEED BOOTS

Fixed Backshoot 50mm

- Adjustable angle
- 50mm closer plate width
- Tungsten tile on closer plate

BS-1240 **\$72**



Split Backshoot 40mm

- 40mm split options
- Adjustable angle
- Tungsten protected closer plate

BS-1260 **\$89**



Flexi Backshoot

- 40mm closer plate
- Better closer plate control in rocky ground
- Suits 38mm OD seed hose

BS-1280 **\$88**



Split Backshoot 70mm

- 70mm paired row seeding
- Centre of each outlet = 70mm
- Adjustable angle and height
- Replaceable closer plate

BS-1262 **\$99**



Fixed Backshoot 30mm

- Adjustable Angle
- 30mm replaceable closer plate
- Tungsten tile and hardfacing on close plate

BS-1230 **\$80**



Side Banded Backshoot

- Left and right available, specify requirements on order
- Adjustable angle and height
- Replaceable closer plate

BS-1290 **\$88**



Backshoot Angles

Standard Tilt Back*

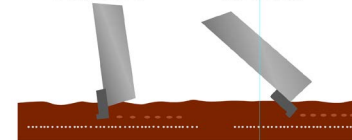

**We recommend tilt back angle when double shooting in heavy soil conditions
Actual closer plate angle depends on shank type image for indicative purposes only*

Closer Plate Section

- Tungsten tile protection
- Available for single or split backshoots

40mm Single	BS-0243	\$19
50mm Single	BS-0244	\$21
40mm Split	BS-0246	\$26
70mm Split	BS-0247	\$27
30mm Single	BS-0239	\$21
Side Banded	BS-0236	\$21
Flexi Boot End	FB-0255	\$39



CULTIVATORS – INLINE SERIES SEED BOOTS

Inline Series seed boots are hard wearing, durable and extremely strong due to their single piece design offering accurate seed and fertiliser placement. Deep banding fertiliser and multiple seed placement options are available. Inline Series boots are very simple to set up for even seed depth control access to the bar.

Features

- Tungsten grit hardfacing for longer wear life
- Deep banding fertiliser
- Accurate and consistent seed placement
- Narrow slim profile for less soil disturbance
- Large outlet holes to minimize plugging
- Liquid fertiliser hole
- **Flat** suits Edge on Tynes
- **Curved** suits C Shank tynes



Slot Mate Razor

We recommend using the Slot Mate Razor with the Inline Series boots, in order to ensure accurate fertiliser placement and achieve the longest wear life in the boot.

For more information see page 4



Flat	IS-1001	\$175
Curved	IS-1006	\$175



Back

Flat	IS-1003	\$175
Curved	IS-1008	\$175



Back

Flat	IS-1002	\$185
Curved	IS-1007	\$185



Back

PRECISION SEEDERS – SEEDING SYSTEMS

Seeding systems and replacements points to suit precision seeders

Bourgault Paralink

Kit price (includes Point, Adaptor, backshoot and fasteners)

PC-3001

\$265

- Height adjustable point
- Liquid ready
- Suits 32mm or 38mm OD hose
- **Kit includes choice of any backshoot**

CK Point – Suit Paralink

PT-1026	Standard	\$79
PT-1027	Liquid	\$89
PT-1028	Liquid Block	\$89



Standard Liquid Liquid block

Morris Contour 2/Quantum

Kit price (includes Point, Adaptor, backshoot and fasteners)

- Height adjustable point
- Liquid ready
- Suits 32mm or 38mm OD hose
- **Kit includes choice of any backshoot**

CT Point – Suit C2 Quantum

- Suits Morris Contour 2 and Quantum
- 125 mm of tungsten



SINGLE SHOOT

PC-2001

\$255



DOUBLE SHOOT

PC-2002

\$300

PT-1030	Standard	\$39
PT-1031	Hardfaced	\$48
PT-1032	SLL	\$54

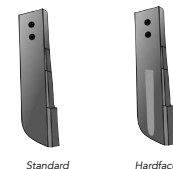

Standard Hardfaced

Backshoot Options

Fixed backshoot
30mm



Fixed backshoot
50mm



Split backshoot
40mm



Split backshoot
70mm



Side banded
backshoot



For more details on backshoots refer page 9

Case Concord

- Single shoot seeding only
- Uses Slot Mate range points (refer to pg4)
- Kit price includes slot mate point

PC-4001

\$220

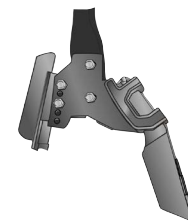

SLOT MATE A

Maxipoint has a range of excellent value high quality replacement parts for Ausplow bars.

Slot Mate A

- Quick change points
- Stronger thicker tongue means no breakages
- Standard 12mm or 15mm Super Long Life tungsten option

6"	PT-1071	\$57
7"	PT-1072	\$57
8"	PT-1073	\$57
6" SLL	PT-1076	\$77
7" SLL	PT-1077	\$77
8" SLL	PT-1078	\$77

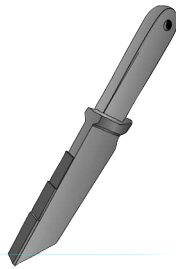

There is no relationship between Maxipoint Cultivation Technologies and Ausplow Pty Ltd. Ausplow Pty Ltd has not approved the use of Maxipoint parts on its machinery

DB Ripper

- Bolt on knife point
- Made from high strength spring steel
- 12mm wide tungsten

7"	PT-115A	\$59
8"	PT-115B	\$61



Slot Mate A – Winged

- 60mm wing for increased soil disturbance

6"	PT-1080	\$85
7"	PT-1081	\$85
8"	PT-1082	\$85



Slot Mate A – Sweep

- Heavy duty sweeps for full cut ripping
- Hardface wear protection

10"	PT-2029	\$54
12"	PT-2030	\$56



Quick Change Adapter

- Fits Slot Mate A range
- Allows quick change of points

PT-1070	\$9.50
---------	---------------

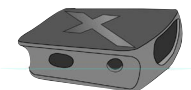

UPGRADES

Trash Guard

Sturdy steel trash guard to give the tyre a streamlined shape.

PT-2008 **\$26**



Hardfacing

Extra hardfacing on the side of points for superior wear protection.

PT-UPH **\$10**

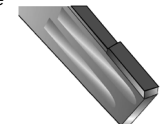

Liquid Nut

To hold liquid tube, specify tube OD on order.

PT-UPN **\$3**



Liquid Block

Similar to nut but gives added protection to the liquid tube. Specify tube OD on order.

PT-UPB **\$12**



CONSERVA PAK

Replacement parts to suit Conserva Pak seeding bars

Conserva Point

- Common replacement knife point for Conserva Pak

PT-1006	Standard	\$65
PT-1019	Hardfacing	\$75
PT-1020	SLL	\$85



Standard



Super Long Life

Conserva Press Wheel

- Semi Solid rubber with aluminium rims.
- Double sealed bearings
- Non greasable
- Optimum profiles for seed soil contact, for use with single or paired row boots

SP-1105	V	\$172
SP-1107	Square	\$172



25mm



80mm

*Specify tyre profile on press wheel order

Fertilisers shoot

- Bolt on replacement
- Hardfaced edges for longer life
- Holders for liquid tube at rear



BS-1286	\$44
---------	------

Press Wheel Scraper

- Tungsten tile protection

SS-1218	\$15
---------	------



Single Row Boot

- Suits conserva pak
- 50mm closer width
- Single row outlet for narrow seed row

BS-1287	\$55
---------	------

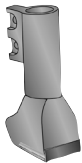

Paired Row Boot

- Full tungsten tile protection on tip and Wing
- Large exit holes. No plugging
- 40mm split row seeding

BS-1285	\$65
---------	------



Conserva Sweep

- Heavy duty sweep for full cut ripping
- Hardface wear protection
- Specify width on order

PT-2025	\$62
---------	------



Press Wheel Scraper

Bushes manufactured in house by Maxipoint using the highest grade materials. See website for more info

Opener SS-1219	\$21
-------------------	------



Seeding Tube SS-1220	\$22
-------------------------	------

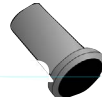

*All prices exclude GST

Making your seeding program more efficient

PRESS WHEELS – SINGLE SYSTEM

The Single Press Wheel units can be mounted either directly onto the cultivator tyne or the U-bolts can be turned to bolt to 50x50 square tube at the rear of the machine

Single Press Wheel System

Wheel Only – V Profile

Wheel Only – Square Profile

SS-1200 **\$320**

SP-1100 **\$155**

SP-1101 **\$155**

Standard Features include:

- Hardened steel bushings on all pivot points.
- Semi-pneumatic “V” or “Flat” profile tyre.
- 2 double sealed wheel bearings, non greasable.
- Strong lightweight aluminum hubs.

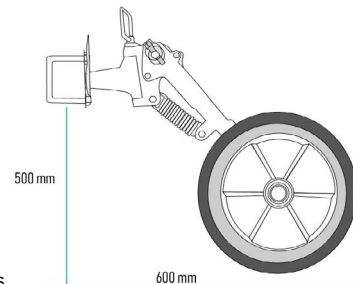

Vertical bar

SS-0109 **\$62**

Mount Bar 'Not Supplied'

Bar Extension SS-0110 **\$155**



PRESS WHEELS – TRIPLES/GANGS

Press Wheel Gangs

- Can be supplied in gangs of 3 or 5 semi pneumatic wheels
- The spring activated pressure system is constructed from 12mm steel
- 6 -13 inch spacings are available

PT-1006	Triple	\$865
PT-1019	5 Gang	\$1280

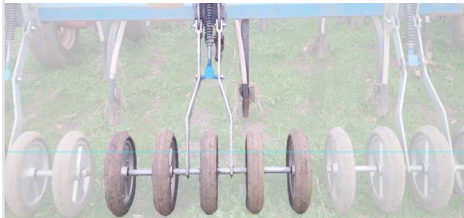

Press Wheel Mounting Framework

- Heavy Duty Swivel Extension bolts to rear of Triple System, allowing wheels to track more accurately through turns
- Reduces drag, saves fuel

TS-1101 **\$145**

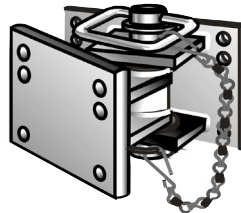

Tyre Profile

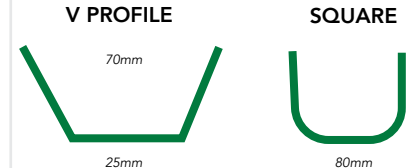

**Specify tyre profile on press wheel order*

Press Wheel Parts

FA-0851	Bearing	\$9
SP-0601	Seal	\$4
SP-0101	Tyre V	\$70
SP-0104	Tyre Flat	\$70



Press Wheel Scraper

- For use in very heavy soil conditions
- Easy to fit and adjust
- Tungsten tipped mud scraper

SS-1216 **\$45**



Triple System Parts

TS-0301	T Piece	\$58
TS-0302	Spring	\$96
TS-0305	Sleeve	\$25
TS-0350	Axle	\$95.50
TS-0304	Saddle	\$34



COULTERS

Our heavy duty couler system is an effective stubble management tool suitable for all bar types. Our coulters have been proven overtime to effectively slice through stubble for easy seeding with virtually no trash build up in and under the seeding bar.

**For questions and information regarding mounting coulters please contact us on 08 9354 1111 or email sales@maxipoint.com.au*

- Available in 9 / 10 / 11 / 12 spacing.
- Wider spacings available on request.
- Heavy duty mounting kit for 100mm SQ tube.
- 150° swivel for better turning.
- Greaseable pivot points.
- Simple depth and pressure adjustment.

Couler Systems	Part No.	Price
Twin Disc Couler System	CS-1300	\$985 + GST
Single Disc Couler System	CS-1301	\$840 + GST



SEED BRAKES

AIRGUARD Seed Brakes are designed to help you achieve consistent optimum air flow across every opener on your air drill to achieve perfect seed and fertiliser placement. Controlled by a series of washers at the exhaust port. The adjustable air speed allows you to match your specific type of opener and achieve more efficiency with no seed bounce.



- **Minimise** seed damage – The seed brake uses a spiral system to slow seed flow: there are no baffles for the seeds to hit against.
- **Lower cost** – AIRGUARD Seed Brakes are competitively priced making it an affordable investment.
- **Deliver durability** – The UV protected plastic withstands harsh weather conditions.
- **Reduce seed waste** – Controlled airflow eliminates seed bounce and seed soil mixing.
- **Improve yield** – With optimum seed and fertilizer placement.
- **Prevent plugging** – Modify airflow to match your specific type of opener.



*Diagram showing airflow through seed brake

Seed Brake			
<ul style="list-style-type: none"> • Improves seed distribution • Durable • SS is highly recommended when single shooting with granular fertilizer 			
32mm	BS-7330	\$43	
38mm	BS-7340	\$48	
38mm SS	BS-7360	\$106	

Full Exhaust Seed Brake			
<ul style="list-style-type: none"> • Ideal for large seeds • Perforated Stainless steel 			
32mm SS	BS-7350	\$35	

Exhaust Port Kit			
BS-7336	\$14		
Adaptor for 38-32mm			
BS-7344	\$7.20		
Wind Meter			
BS-7400	\$45		

For setup and installation videos please visit maxipoint.com.au



*All prices exclude GST

Making your seeding program more efficient

BLOCKAGE PREVENTION SYSTEMS

The Airguard Blockage Prevention System keeps the tubes of your air seeder free from plugging. By attaching it directly to the air intake of your drill, this oil cooler reduces oil temperature and moisture levels for optimum flow.

- **Seed in wet or dry conditions** – Heats air by 10°C to reduce condensation and plugging issues.
- **Reduce humidity** – Significantly decreases the moisture in your air drill to reduce plugging.
- **Lower oil temperature** – Increasing the life of your oil and less wear on your tractor.
- **Use dusty fertilizers** – Eliminates plugging with powdery fertilizers.
- **Seed in wet and dry conditions** – Work in humid conditions without plugging issues by heating the air at intake.



Air Cart Fitment

Airguard Blockage Prevention Systems come with a specific bracket included to suit almost every air cart on the market. When ordering please specify your air cart model. For fitment questions or product suitability contact Maxipoint.

Blockage Prevention System

Includes bracket
(Brackets available to suit any air cart)
\$2,980

Airguard Snorkel Kit

The Airguard Snorkel Kit keeps your fan screen from plugging and eliminates build-up of dust on internal components like manifolds and meters.

- **Reduce Build-up of Residue** – Stops fan from sucking in chaff and dirt.
- **Prevent Plugging** – Eliminates build-up of dirt on meters, manifolds and openers.
- **Single or Dual** – Available in Single 8" flex hose for lower air flows or dual for higher capacity fans.
- **Optional Cooler Kit** – Snorkel is available with or without the cooler assembly.

Relief Kit

Relief kit price depends on TBH/TBT and drawbar length
Prices ex GST. Contact Maxipoint for a quote.
\$600 - \$1,200



BS-7676

\$1399 + GST



FASTENERS AND ACCESSORIES

Hex Bolts

FA-0315	7/16 x 2¼	\$1.10
FA-0316	7/16 x 2½	\$1.10
FA-0317	7/16 x 2¾	\$1.10
FA-0321	1/2 x 2¼	\$0.90
FA-0322	1/2 x 2½	\$0.90
FA-0323	1/2 x 2¾	\$0.90
FA-0324	1/2 x 3	\$1.40
FA-0337	1/2 x 3½	\$2.20

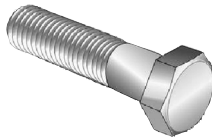

Pins

FA-0802	Lynch Pin	\$0.90
FA-0803	HD Lynch Pin	\$1.80
FA-0804	Leech Pin	\$7.50
PT-10EP	Roll Pin	\$0.90
FA-0801	Split Pin	\$0.90



U-Bolts

FA-0703	M12 x 50 x 60 Leg	\$5.50
FA-0702	M12 x 50 x 80 Leg	\$6.00
FA-0704	M12 x 75	\$8.00
FA-0705	M12 x 100	\$10.50
FA-0708	M10 x 50 Curved	\$6.50
FA-0710	M16 x 50	\$18.00
FA-0711	M16 x 100	\$23.00

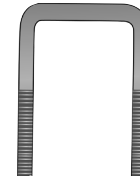

Washers

FA-0555	7/16" Flat	\$0.20
FA-0560	7/16" Spring	\$0.20
FA-0556	1/2" Flat	\$0.20
FA-0561	1/2" Spring	\$0.20

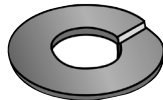

Plough Bolts

FA-0380	7/16 x 2¼	\$1.70
FA-0381	7/16 x 2½	\$1.70
FA-0382	1/2 x 2½	\$1.70

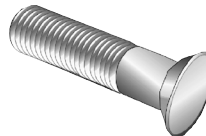

Nuts

FA-0409	7/16" Nyloc	\$0.40
FA-0410	1/2" Nyloc	\$0.40
FA-0434	1/2" Cone Lock	\$0.40

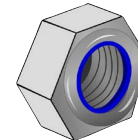

NOTES



**Making your seeding
program more efficient.**



Tel 08 9354 1111 | **Fax** 08 9354 3789
sales@maxipoint.com.au

HEAD OFFICE

69-71 Catalano Circuit, Canning Vale WA 6155

EASTERN STATES DEPOT

36 Long Street, Goulburn NSW 2580

maxipoint.com.au

Terms and Conditions

All prices in the product and price guide are recommended retail pricing only and exclude GST. Maxipoint reserves the right to change prices and specifications without notice. Maxipoint recommends that you consult your agronomist to determine suitability of Maxipoint products for your application. Maxipoint will not accept liability for any loss or damage caused by or as a consequence of the use of its products.

Warranty

Maxipoint offers a full replacement warranty for any faulty products. Maxipoint pays freight on replacements. Warranty is valid for 1 year from the date of purchase and covers all Maxipoint products. For more warranty information please see our warranty claim form on the website or speak to your supplying dealer.