

2017

PRODUCT & PRICE GUIDE



OCT 2016 - SEP 2017

ALL PRICES RRP AND EXCLUDE GST

WWW.MAXIPOINT.COM.AU

Point Boot Kits
Knife Points
Ezi Fit System
Slot Mate Range
Seed Boots
Back Shoots
Inline Series
Precision Seeder Parts
Press Wheels
Coulters
Seed Brakes

NEW
Super Long Life

• Extra Tungsten • Extra Hardfacing
Exceptional Wear Protection
Available on selected points

POINT BOOT KITS





 <p>SLOT MATE KNIFE POINT AND SINGLE SHOOT FIXED BOOT PB-1000 \$145 + GST</p>	 <p>SLOT MATE KNIFE POINT AND SINGLE SHOOT SPLIT BOOT PB-1100 \$153 + GST</p>	 <p>SLOT MATE KNIFE POINT AND SINGLE SHOOT FLEXI BOOT PB-1200 \$157 + GST</p>
 <p>SLOT MATE KNIFE POINT AND DOUBLE SHOOT FIXED BOOT PB-2000 \$163 + GST</p>	 <p>SLOT MATE KNIFE POINT AND DOUBLE SHOOT SPLIT BOOT PB-2100 \$171 + GST</p>	 <p>SLOT MATE KNIFE POINT AND DOUBLE SHOOT FLEXI BOOT PB-2200 \$175 + GST</p>

All Point & Boot Kits include:

- Boot Kit
- Slot Mate Knife Point
- Slot Mate Adaptor
- 2 x 2 3/4 x 1/2 Gr. 8 Hex Bolt/Nut
- Lynch Pin
- All other Bolts & Nuts to suit

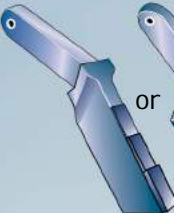
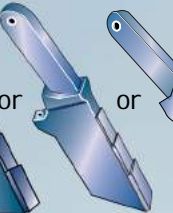
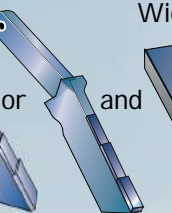
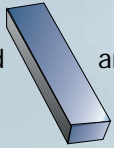
When ordering a Point Boot Kit please specify machine or tyne/shank. Maxipoint Seed Boots can fit the below shank tynes:

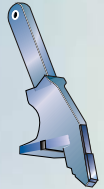
- C-Shank (standard)
- Simplicity
- Horwood Straight/Curved
- Gason
- Flexicoil Edge On
- And more.

SMV	SMS	SMD	12 or 15mm Wide	Choice of 7/16 or 1/2	SMF	Trash Guard	SLL
	or 	or 	and 	and 			
INCLUDED	INCLUDED	INCLUDED	INCLUDED	INCLUDED	Add \$6.00	Add \$24.00	Add \$20.00

When ordering a point/boot kit please specify the knife point and tungsten width (only 12mm available on SMD). Suitable for all 50mm C shank tines with 45-57mm hole centres. If unsure about suitability or machine fit check with your dealer. For edge on boot frames refer your dealer or Maxipoint.

KNIFE POINTS

<p>MAXI KNIFE No till design with good penetration and tungsten tipped leading edge. Use one 2 1/4 x 7/16 UNC B & N. PT-1002 \$42³⁰ + GST Reg. Trade Mark 947030.</p>	<p>1 BOLT RIPPER Combine Cultivator - SG Iron • HD direct drill, no till. • Fits most systems. • Tungsten leading edge. Use one 2 1/4 x 7/16 UNC B & N. PT-1007 \$44⁸⁰ + GST</p>	<p>MAXI SEEDER Inverted "T" design for minimum till application with improved seed depth control. Tungsten tipped leading edge & wing protection. Use one 2 1/4 x 7/16 UNC B & N. PT-1001 \$50⁹⁰ + GST Reg. Trade Mark 947158.</p>	<p>MAXIPLUS Around 50% longer life. Inverted "T" design for minimum till, stronger neck plus • Thicker Tungsten • Deeper banding • Tougher wings. Use one 2 1/4 x 7/16 UNC B & N. PT-1004 \$57⁰⁰ + GST Reg. Trade Mark 947086.</p>
<p>SCARI RIPPER Scarifier - SG Iron • Heavy duty direct drill, no till. • Fits most systems. • Tungsten leading edge. Use one 2 1/2 x 1/2 UNC B & N. PT-1009 \$54⁸⁰ + GST Reg. Trade Mark 947069.</p>	<p>FLEXIPLUS Around 50% longer life. Inverted "T" design for minimum till plus • Stronger neck • Thicker Tungsten • Deeper banding • Tougher wings. Use two 2 1/4 x 7/16 UNC B & N. or 2 1/4 x 1/2 UNC B & N. 7/16" PT-105A \$65¹⁰ + GST 1/2" PT-105B \$65¹⁰ + GST Reg. Trade Mark 947034.</p>	<p>BT POINT • To suit Bourgalit paralink Titan Series. • A = Original • B = 1/2" longer • C = 1" longer</p>	<p>PASTURE POINT PT-1014 = Connor Shea, Agrow & Aitchison PT-1015 = Duncan PT-1014 \$49³⁰ + GST PT-1015 \$49³⁰ + GST A PT-1016 \$68⁵⁰ + GST B PT-1017 \$68⁵⁰ + GST C PT-1018 \$68⁵⁰ + GST</p>

EZI BLADE

This knife uses the standard "Slim Line" Wedge System. Made from a cast steel which has the same consistency as spring steel and has a working angle (draft) designed for minimum soil throw. Prices include pin. Wedge is additional.

VERTICAL	PT-113V
STRAIGHT	PT-113S
127mm	
\$54⁵⁰ + GST	

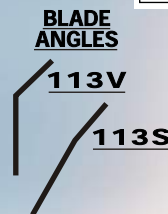

CURVED	PT-112A
FLAT	PT-112B
\$60¹⁰ + GST	

DYNA BLADE

Curved or Flat
The Dyna Blade is a popular standard knife point. It has 1/2 inch slots on flat or curved tongues. Made from spring steel and is designed for minimal soil throw.

- 6 inch digging depth

Reg. Trade Mark 826682

ADAPTORS

WEDGE



45mm - 57mm Hole Centre
Wedges with 1/2" & 7/16" Holes.

1/2 x 45	PT-1MW1
7/16 x 45	PT-1MW2
1/2 x 57	PT-1MW3
\$15⁸⁰	
+ GST	

2 BOLT HOLE ADAPTER

Suits two-bolt tyne and single-bolt points.



PT-2011
\$20⁰⁰
+ GST

WEDGE ADAPTER

Fits on most Wedges for use on two-bolt Cultivators and Chisel Plows

Design Reg. No.139419



PT-1EWA
\$21⁶⁰
+ GST

2-BOLT CURVED ADAPTER

Fits two-bolt Cultivators and Chisel Plows



PT-1E48
\$36¹⁰
+ GST

CULTI ADAPTOR

Suits single bolt 7/16 combine tyne



PT-1EW46
\$27³⁰
+ GST

SCARI ADAPTER

Fits scarifier tyne. Use one 2 1/2 x 1/2 UNC B & N

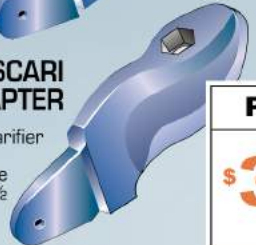

PT-SA
\$31²⁰
+ GST

EZIFIT SYSTEM

PT-10ER

EZI RIPPER

Reg. Trade Mark 947159.

\$43⁹⁰
+ GST

STEALTH RIPPER

PT-10SR	\$45.70
---------	----------------

Stealth option available to suit flexicoil stealth.



PT-10DR

DEEP RIPPER

\$44²⁰
+ GST

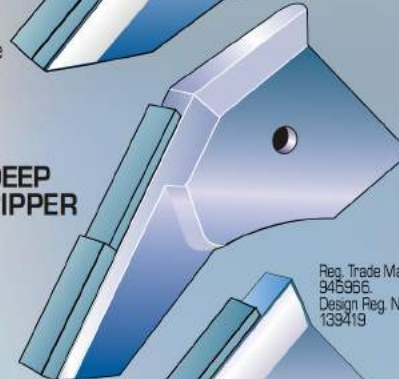

Reg. Trade Mark 945966.
Design Reg. No. 139419

PT-10ES

EZI SEEDER

with Tungsten Wing.

\$48¹⁰
+ GST



STEALTH SEEDER

PT-10SS	\$55.80
---------	----------------

Stealth option available to suit flexicoil stealth.



PT-10DS

DEEP SEEDER

with Tungsten Wing.

\$48⁸⁰
+ GST



PT-10ET

EZI TILLER

\$49⁵⁰
+ GST



ROLL PINS

PT-10EP	\$0.90
---------	---------------

*ALL PRICES GST EXCLUSIVE

SLOT MATE A

QUICK CHANGE HEAVY DUTY KNIFE POINT SYSTEM

- Slot Mate equivalent of DB Ripper.
- Vertical knife point, minimal soil throw.
- Stronger thicker tongue to allow for higher breakout.
- Available in 6", 7" or 8" depths.
- 12mm wide tungsten.



TRASH GUARD

SLOT MATE A WINGED

- 60mm wing for increased soil disturbance.

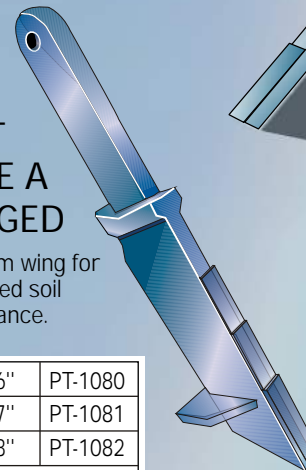

6"	PT-1080	
7"	PT-1081	
8"	PT-1082	
		\$72.80 + GST

6"	PT-1071	\$55.50 + GST
6" SLL	PT-1076	\$75.50 + GST
7"	PT-1072	\$56.50 + GST
7" SLL	PT-1077	\$76.50 + GST
8"	PT-1073	\$56.50 + GST
8" SLL	PT-1078	\$76.50 + GST
Adaptor	PT-1070	\$9.50 + GST
Trash Guard	PT-2008	\$26.00 + GST

One Heavy Duty Lynch Pin is included with every point.

DB RIPPER

- Vertical bolt on knife point.
- Minimal soil throw.
- Made from spring steel.
- Available in 7" or 8" depths.
- 13mm wide tungsten.
- Optional nut welded on back of point for liquid fertiliser.



UPGRADES

- Nut welded to rear of point \$1.50
Add N to part number.

7"	PT-115A	\$56.20 + GST
8"	PT-115B	\$59.80 + GST

SLOT MATE RANGE

QUICK RELEASE!

SLOT MATE 'V'



12mm	PT-1SMV	\$51.80 + GST
15mm	PT-1SMV5	\$55.80 + GST
SLL	PT-1SMV8	\$75.80 + GST

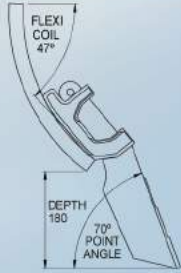

- Effective Working Angle.
- 7-Inch Digging Depth.
- Most common standard knife point in the Slot Mate Range.

SLOT MATE 'S'

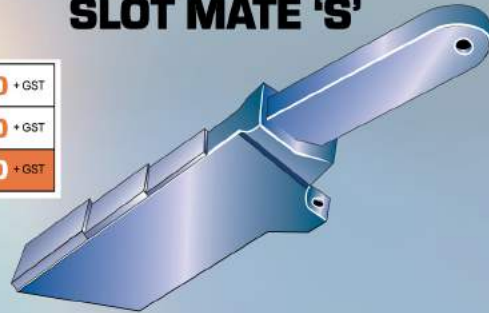

12mm	PT-1SMS	\$52.80 + GST
15mm	PT-1SMS5	\$56.80 + GST
SLL	PT-1SMS8	\$76.80 + GST



- Hard and resilient - won't crack under shock loads.
- Straighter angle means less pulling power and more soil throw.

TRASH GUARD



- Trash guard to fit around the Slot Mate adaptor.
- Slot Mate points still able to be quickly removed and inserted with guard fitted.
- Adaptor not included in price.

PT-2002
\$24.00
+ GST

SLOT MATE 'E'

- Adaptor to accommodate Points of the Ezi Fit System.

PT-SMEA
\$17.20
+ GST

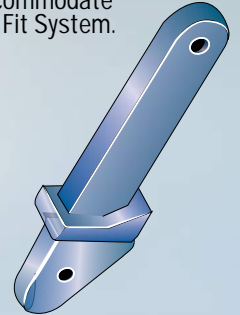

SLOT MATE SWEEP

4"	PT-2020	\$21.00 + GST
6"	PT-2021	\$24.00 + GST
8"	PT-2022	\$29.00 + GST
10"	PT-2023	\$33.00 + GST
12"	PT-2024	\$37.00 + GST

- Quick change steel sweep.
- Hard faced tip.

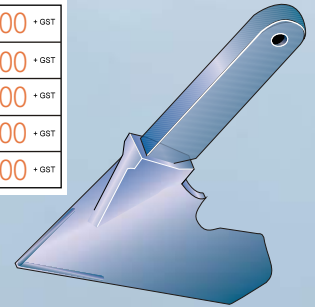

SLOT MATE 'D'



PT-1SMD
\$53.60
+ GST

- Dyna Blade type design.
- 6-Inch Digging Depth.

SLOT MATE 'F'

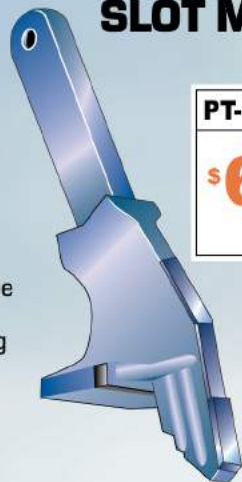

PT-1SMF12
\$68.50
+ GST

- Inverted T Design to increase soil disturbance and create a flat seed bed.
- Extra rib protection for longer wear.

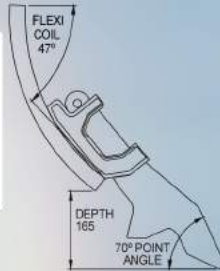

SLOT MATE 'T'

- Adaptor to take 2-Bolt Steel Points.

PT-SMTA
\$24.00
+ GST

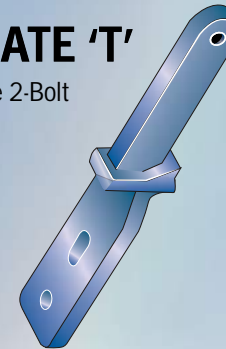

SLOT MATE ADAPTER

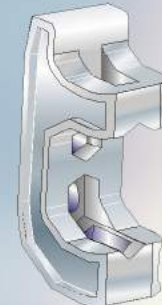

1/2"	PT-1SMA12
7/16"	PT-1SMA7/16
\$9.00	
+ GST	

Fits all these GENUINE TOP BRAND SEEDING MACHINES:



PLUS MANY MORE!

DEEP BANDING FERTILISER

TYNE FRAMES

SINGLE SHOOT



SB-0231
Single Tyne Frame
\$46⁰⁰
+ GST

DOUBLE SHOOT

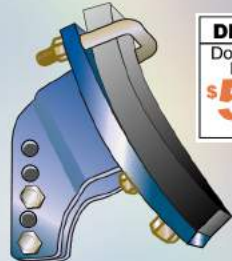

DB-0220
Double Tyne Frame
\$51⁰⁰
+ GST

- Heavy Duty construction.
- 2 large slots to fit all 2 bolt tynes.
- Adjustable height positions.
- When ordering a Boot Kit or tyne frame please specify machine or tyne/shank type. Maxipoint Seed Boots can fit the below shank tynes. (For more tynes see page 11).

HEIGHT OPTIONS

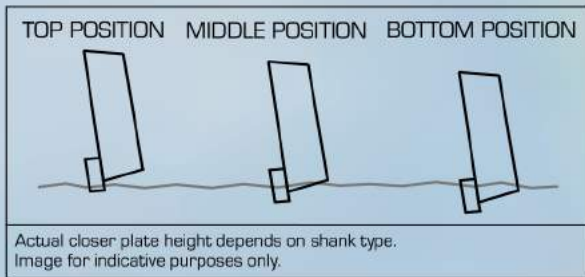

MACHINE FIT

C-SHANK (standard)
GASON
HORWOOD STRAIGHT
HORWOOD CURVED
SIMPLICITY
FLEXICOIL EDGE ON
JOHN SHEARER
RYAN

ADJUSTABLE SEED PLACEMENT

BACKSHOOTS



BS-1240
\$70⁰⁰
+ GST

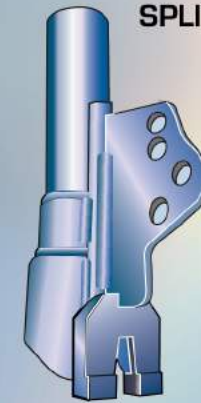

BS-1260
40mm Split
\$79⁰⁰
+ GST

BS-1262
70mm Split
\$89⁰⁰
+ GST

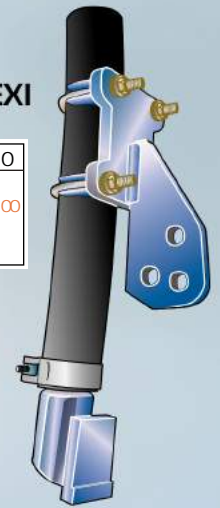

BS-1280
\$83⁰⁰
+ GST

- 50mm wide closer plate with tungsten tile wear protection.
- Adjustable angle to reduce clogging in heavy conditions.

- 40mm or 70mm split options.
- Adjustable angle.
- Tungsten protected closer plate.

- Keeps the closer plate in the ground on lower breakout tynes.
- 40mm closer plate.



40mm Split



70mm Split

BACKSHOOT ANGLES

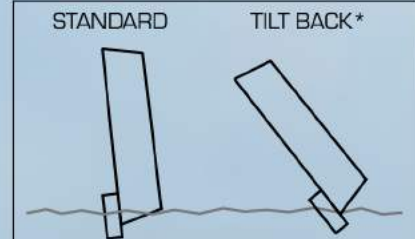

* We recommend tilt back angle when double shooting in heavy soil conditions. Actual closer plate angle depends on shank type. Image for indicative purposes only.

BOOT KIT PRICING

SB-1230
SINGLE SHOOT FIXED
\$92⁰⁰
+ GST

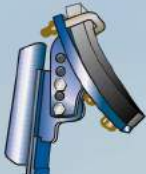

SB-1232
SINGLE SHOOT SPLIT
\$100
+ GST



SB-1234
SINGLE SHOOT FLEXI
\$104
+ GST

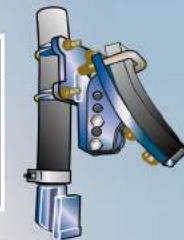

DB-1220
DOUBLE SHOOT FIXED
\$110
+ GST

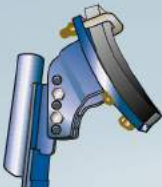

DB-1222
DOUBLE SHOOT SPLIT
\$118
+ GST



DB-1224
DOUBLE SHOOT FLEXI
\$122
+ GST

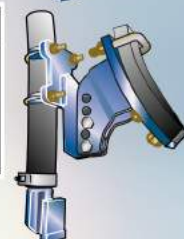

Bolts and fasteners included with all boots kits. For more boot options and individual part pricing please visit our website or give us a call.

For SB-1232 & DB-1222 specify 40mm or 70mm split backshoot.

OPTIONS

BACKSHOOT HOSE ADAPTORS

Suits 32mm Seed Hose		Suits 38mm Seed Hose	
BS-0350	BS-0352	BS-0354	BS-0356
\$3⁵⁰	\$6⁵⁰	\$5⁰⁰	\$9⁵⁰

Can be fitted by tek-screwing or welding in. We recommend the curved adaptors if using backshots on tilted back angle.

CLOSER PLATE (to weld on)

- Tungsten tile protection.

40mm **BS-0243**
50mm **BS-0244**
\$19⁰⁰
+ GST



FIXED BOOT TOOL KIT
TO-1118 \$179

FLEXI BOOT TOOL KIT
TO-1120 \$188

INLINE SERIES SEED BOOT

Suits 32mm and 38mm hoses.

Suits most 2 bolt cultivator tyres.

IS-1001
Paired Row
\$165
+ GST

Large seed exit holes, precision placement, no plugging.

Deep banding fertiliser shoot, large exit hole, no blocking.

Tungsten grit hard faced for long life wear protection.

2 liquid fertiliser depth positions

FEATURES

- Accurate seed placement.
- Heavy duty robust design.
- Liquid fertiliser ready.

IS-1002
Side Banded
\$115
+ GST



SIDE BANDED



PAIRED ROW



BACK VIEW PAIRED ROW

PRECISION SEEDERS

FLEXICOIL PD-5700

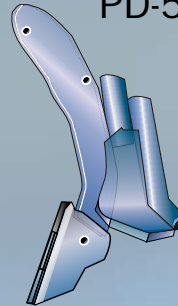

PC-1001
Paired Row
\$295
+ GST

PC-1002
Side Banded
\$265
+ GST

- Paired Row System or Side Banded options.
- Point included in price PT-10ER (see page 4).

MORRIS CONTOUR 2

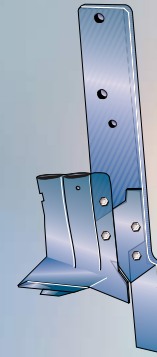

PC-2001
\$305
+ GST

- Paired Row System or choice of Maxi Backshoots (see page 9)
- Point included in price.

BOURGAULT PARALINK

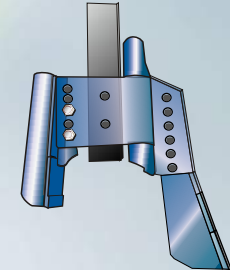

PC-3001
Double Shoot
\$252
+ GST

PC-3002
Single Shoot
\$208
+ GST

- Price includes holder, point and backshoot.
- Choice of Maxi Backshoots (see page 9).

CASE CONCORD

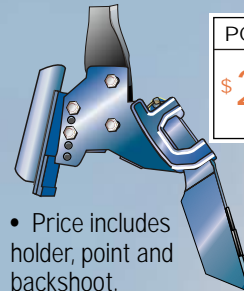

PC-4001
\$205
+ GST

- Price includes holder, point and backshoot.
- Choice of Maxi Backshoots (see page 9).

WEAR POINTS



PT-1026
\$79.00
+ GST

- Suits Bourgault Paralink.



PT-1030
\$45.00
+ GST

- Suits Morris Contour 2.

WARRANTY NOTE

Fit in the uppermost position when new. These points are designed to be adjusted down only as they wear. No responsibility or warranty cover will apply if fitted and used outside OEM design parameters.

CONSERVA PAK

CONSERVA POINT



PT-1006
\$65.70
+ GST

- Suits Conserva Pak.

SEED BOOT

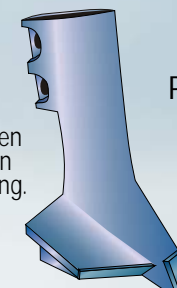

BS-1285
\$60.00
+ GST

- Full tungsten tile protection on tip and wing.
- Large exit holes, no plugging.

FERTILISER SHOOT

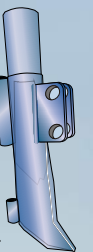

BS-1286 **\$42**

PRESSWHEEL SCRAPER



SS-1218 **\$15**

- Tungsten tile protection.

BUSHINGS



SS-1219 **\$9.50**

- Suits fertiliser shank.

SINGLE PRESS WHEEL UNIT

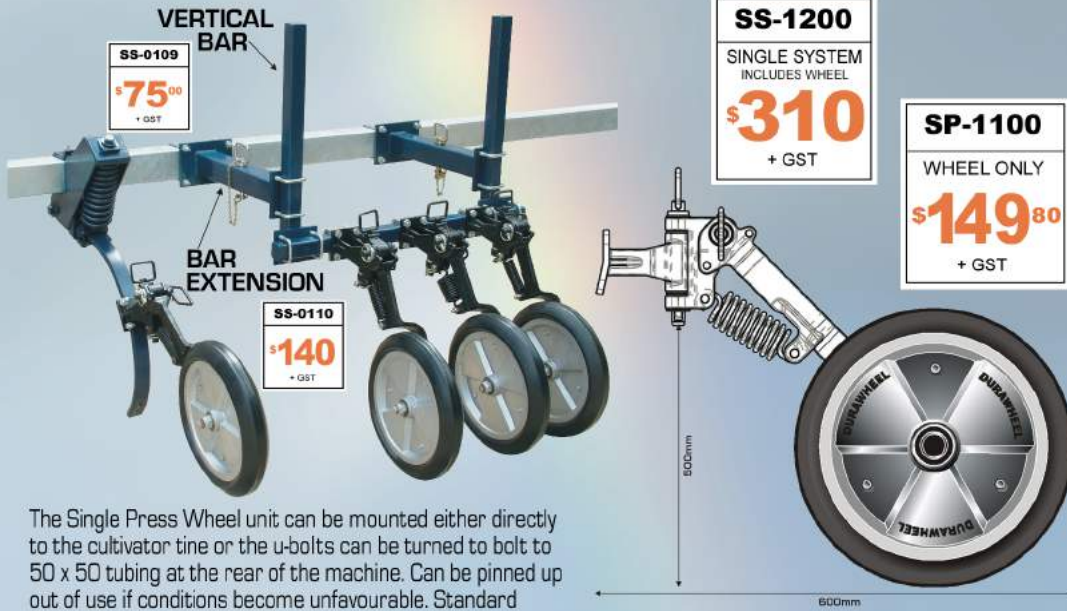

The Single Press Wheel unit can be mounted either directly to the cultivator tine or the u-bolts can be turned to bolt to 50 x 50 tubing at the rear of the machine. Can be pinned up out of use if conditions become unfavourable. Standard features include:

- Hardened steel bushings on all pivot points.
- Pressure adjustable using mounting frame or u-bolts.
- Semi-pneumatic "V" or "Square" profile tyre on alloy wheel.
- 2 double sealed wheel bearings, non greasable.

PRESS WHEEL SCRAPER



PRESS WHEEL PARTS

Spring	SS-0610	\$33.00 + GST
Bearing	FA-0851	\$8.45 + GST
Seal	SP-0601	\$4.10 + GST
Tyre V	SP-0101	\$61.00 + GST
Tyre Square	SP-0104	\$61.00 + GST



TRIPLE / 5 GANG SYSTEM



The above system can be supplied in gangs of 3 or 5 semi pneumatic wheels. The spring activated pressure system is constructed from 12mm steel. 6, 7, 8, 9, 10, 11, 12 inch spacings are available on order.

TS-1300 3-WHEEL \$825 + GST	TS-1500 5-WHEEL \$1240 + GST
---	--

TYRE PROFILE

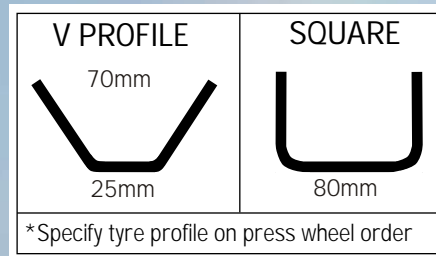

TRIPLE SYSTEM PARTS

T Piece	TS-0301	\$58.00 + GST
Spring	TS-0302	\$95.85 + GST
Sleeve	TS-0305	\$25.10 + GST
Axle	TS-0350	\$65.50 + GST
Saddle	TS-0304	\$34.00 + GST

PRESS WHEEL MOUNTING FRAMEWORK

Heavy Duty Swivel Extension bolts to rear of Triple System, allowing wheels to track more accurately through turns. Reduces drag, saves fuel.

TS-1101 \$135 + GST



PRESS WHEEL TOOL KIT

TO-1122	\$279
---------	--------------

COULTERS

TWIN DISC COULTER SYSTEM



- Available in 9, 10, 11 and 12 inch spacing. Other spacings are available on request.
- Heavy duty hubs.
- 150° swivel for trouble-free cornering.
- Greaseable pivot points.
- Depth and pressure can be adjusted quickly and easily.
- Available with Flat or Rippled disc.
- Fits most systems. For mounting information contact Maxipoint.

CS-1300
\$865
 + GST



SEED BRAKES

NEW TO MAXIPOINT - AIRGUARD™ SEEDING PRECISION

Improve seed germination and crop consistency through optimum seed and fertilizer placement. Controlled by a series of washers at the exhaust port, the adjustable air speed allows you to match your specific type of opener.

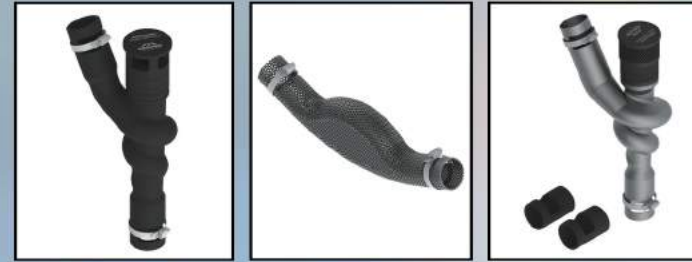

BS-7330

BS-7350

BS-7360
 BS-7344 (adaptors)

BS-7330	Seed Brake - 32mm	\$37.80
BS-7340	Seed Brake - 38mm	\$43.20
BS-7350	Full Exhaust Seed Brake - 32mm SS	\$35.10
BS-7360	Seed Brake - 38mm SS	\$106.00
BS-7400	Wind Meter	\$45.20
BS-7336	Exhaust Port Kit	\$13.50
BS-7344	Adaptor Kit for 7340 /7360 - 38-32mm	\$9.70

For more information visit www.maxipoint.com.au.

SPARE PARTS

Visit www.maxipoint.com.au to see our spare parts for Maxipoint Boot, Press Wheel and Coupler Systems. List of commonly sold spare parts:

- Hardened steel spacers
- Bearings
- Seals
- Rubber Tyres
- Springs
- Pins
- Axles



FASTENERS

Maxipoint now has a Fastener range of 400+ items including Hex Bolts, 8.8 Hex Bolts, Plow Bolts, Grade 8 UNC Bolts, Washers, Nuts and U-Bolts. If you need Bolts & Nuts, get them sent with your points and save time and hassle.

NUTS

FA-0409	7/16 Nyloc Nut	\$0.40
FA-0410	1/2 Nyloc Nut	\$0.40

LYNCH PINS

FA-0802	Lynch Pin	\$0.90
FA-0803	HD Lynch Pin	\$1.30

COMMON BOLT SIZES

FA-0315	7/16 x 2¼	\$1.10
FA-0316	7/16 x 2½	\$1.10
FA-0317	7/16 x 2¾	\$1.10
FA-0321	½ x 2¼	\$0.90
FA-0322	½ x 2½	\$0.90
FA-0323	½ x 2¾	\$0.90
FA-0324	½ x 3	\$1.40
FA-0337	½ x 3½	\$2.20

WARRANTY

Maxipoint offers a full replacement warranty for any faulty products. Maxipoint pays freight on replacements. Warranty is valid for 1 year from date of purchase and covers all Maxipoint products. Here at Maxipoint, we stand by our products and place extremely high emphasis on manufacturing standards. For more warranty information please see our warranty claim form on the website or speak to your supplying dealer.

TERMS & CONDITIONS

All prices in this product and price guide are recommended retail pricing only and exclude GST. Maxipoint reserves the right to change prices and specifications without notice. Maxipoint recommends that you consult your agronomist to determine suitability of Maxipoint products for your application. Maxipoint will not accept liability for any loss or damage caused by, or as a consequence of the use of its products.

NOTES

***Over 300 Dealers
Australia Wide!***

Find your dealer at www.maxipoint.com.au

IMPORTANT NOTICE

All prices contained in this publication are suggested prices only and there is no obligation on resellers to comply with the recommendation.

Due to our policy of continuous improvement, product specifications may change without notice. Actual products may differ from illustration.

Your local authorised Maxipoint Dealer

MAXIPOINT
CULTIVATION TECHNOLOGIES

FREE CALL: 1800 658 444
69-71 CATALANO CIRCUIT, CANNING VALE

PH: 08 9354 1111 • FAX: 08 9354 3789 • SALES@MAXIPOINT.COM.AU